



Tucker® Pole Systems 3-Stage RO/DI Cart User Manual

RHG Products Company
www.rhgproducts.com
303-663-1779

TUCKER®

Mobile RO/DI Water Purification Cart System Layout

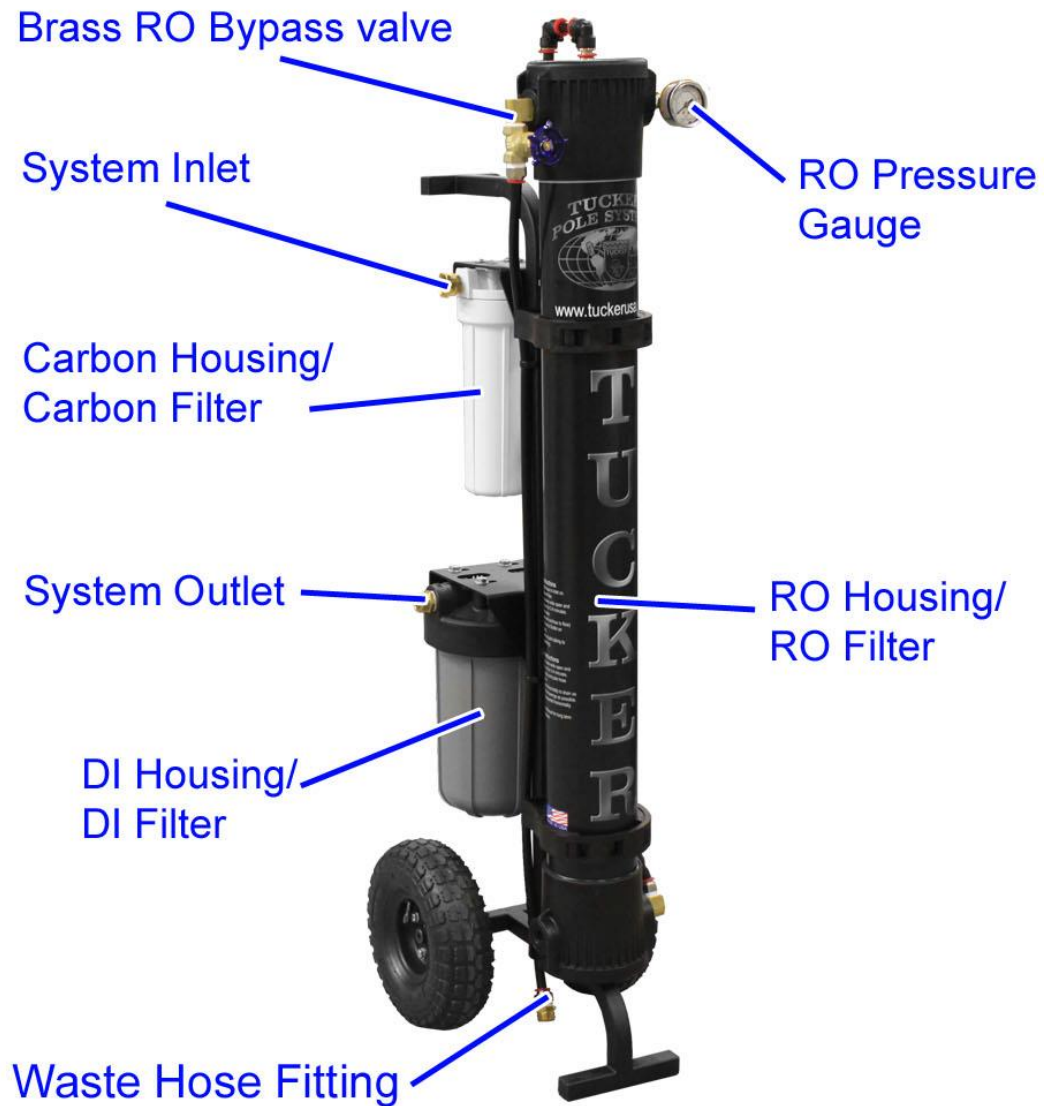

New Machine Setup Procedure

1. Unpack unit and inspect for any damage that may have occurred during shipping.
2. Be sure to inventory all items that were to be included with your order.
3. Any damage or missing components must be reported within 24 hours to the supplier of your system.
4. Your Tucker® Cart is shipped complete in 1 box.

Operation Instructions

First time use:

1. Attach a garden hose to the inlet of your system.
2. Attach a hose (pole hose or hose reel) to the outlet of your system.
3. Turn tap water supply on. Start your system with the bypass valve fully open.
4. As water begins to flow out of the bypass line, close the bypass valve all the way. Although the valve is fully closed, water will still flow out of it. This is normal.
5. It will take a few minutes for all of the air to purge out of your system before water makes its way out of the reel.
6. After the initial 'air purge' you will not need to purge air again unless you replace a filter.
7. You are now fully operational.

Every day use:

1. Attach your tap water supply as you did on set up.
2. Turn tap water supply on. Always start your system with the bypass valve fully open.
3. Allow system to flush for a few moments before beginning production.
4. Attach cleaning equipment to system and close bypass valve to begin production

Shutdown Procedure

1. Open the bypass valve fully to flush the system.
2. Flush the system for 4 to 5 minutes at the end of the job.

**If you leave the unit inoperative for longer than 2 weeks, remove your DI and run the RO in flush mode for 4 minutes and RO production mode for 10 minutes before replacing the DI filter.

3. Turn off the water supply to the unit.
4. Disconnect the water supply.

It is important to always flush the system after each use. Failure to do so will decrease the filters life.

Maintenance

It is important to check the TDS level of the water coming from your system occasionally. This can be done by filling a cup with the water from your reel and testing it with your handheld TDS meter.

Once the TDS levels rise above 10 parts per million you will begin to see spotting on windows and should consider changing your DI Filter.

The carbon/sediment cartridge needs to be replaced after approximately 5000 gallons to protect the RO membranes. Failure to do so will void your warranty. The job of the carbon filter is to remove the chlorine. It is possible to check to see if your carbon filter is still working efficiently with a chlorine test kit.

Your Tucker® Cart is a water purification system and as such it needs to be maintained. Running water through the RO membranes every 2 weeks will help to keep the ROs working at peak performance. Do not ever drain your system as it is important to keep the filters hydrated.

Filter Replacement Schedule & Procedure

Your carbon filter protects your system from damaging chlorine and water disinfection agents. It is recommended that you change your carbon filter cartridge every 5000 gallons. Failure to do so will void your warranty. Order RHG #20026.

Your DI filter has a limited lifespan based on the amount of dissolved solids it is removing from the water. DI filter cartridges need to be replaced as needed for your cleaning application.

Order RHG #20027

To remove these filters, slide the correctly sized provided plastic wrench over the filter housing from the bottom up. Once snug, turn the filter counter-clockwise (as viewed from the bottom of the filter) to

break any seal that may have formed. Once the housing is loose, continue unthreading housing sump from the housing head. Remove spent filter and replace. Ensure the rubber washers provided with your replacement filter are correctly placed and aligned. All rubber seals, including the large diameter O-ring around the mouth of the housing, should be lubricated at this time.

RO membranes have a much longer service life and in the experience of RHG may last the life of the system. However ROs are only warranted for factory defect and may eventually diminish in performance or fail. If you experience a reduction in RO performance in your Tucker® Cart, contact RHG directly to troubleshoot.

To change your RO Membrane, first disconnect any hoses from the elbow in the insert at the top of the filter housing. Remove locking safety wedge and phillips head screw. Remove snap ring, and filter housing insert. Remove membrane and replace.

To install the new filter, you may need to relubricate your filter housing insert which also ensures a tight seal. The white nipples on each end of the membrane will likely need to be lubricated to seat into the O-rings in the top and bottom of the housing. Use a silicone valve stem lubricant. RHG uses Dow Molykote 111. Put the new filter into the housing the same way the previous one was installed. There is a white O-ring on the membrane. This O-ring should go at the top end of the housing. Insert the membrane from the opposite end first. Be sure to run water through the system without any booster motor/pump assembly powered on to purge all air out of the system before or you risk damaging the filters.

Reassemble filter housing and reconnect hoses.

RO MEMBRANES SHOULD NOT BE ALLOWED TO DRY OR COLLECT STAGNANT WATER IN THE BOTTOM OF THE MEMBRANE. THIS WILL DIMINISH PERFORMANCE, POTENTIALLY TO THE POINT OF FAILURE. TO PREVENT THIS, ROs SHOULD BE RUN ON A REGULAR BASIS, AT LEAST EVERY TWO WEEKS, AFTER FIRST USE, EVEN DURING "OFF-SEASON".

RHG Serviceable Housing

Hub Removal Instructions



Step 1:
Remove Stainless
Steel U-Pin

Step 2:
Insert U-Pin
into oval holes

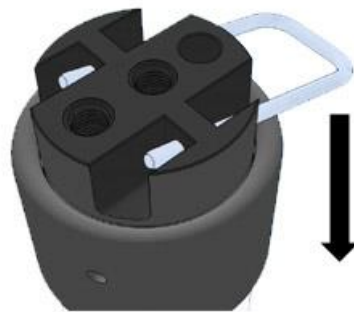
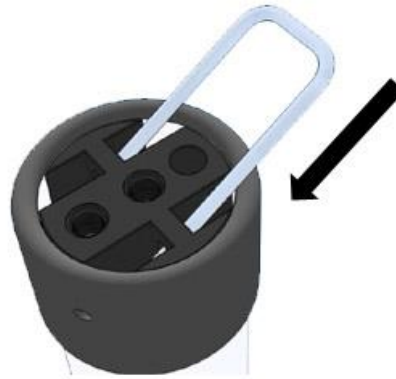

Step 3:
Use U-pin
as a pry tool
to leverage out hub

Any alterations to your system will void its warranty.